

TECHNICAL BULLETIN: THREAD SEALS

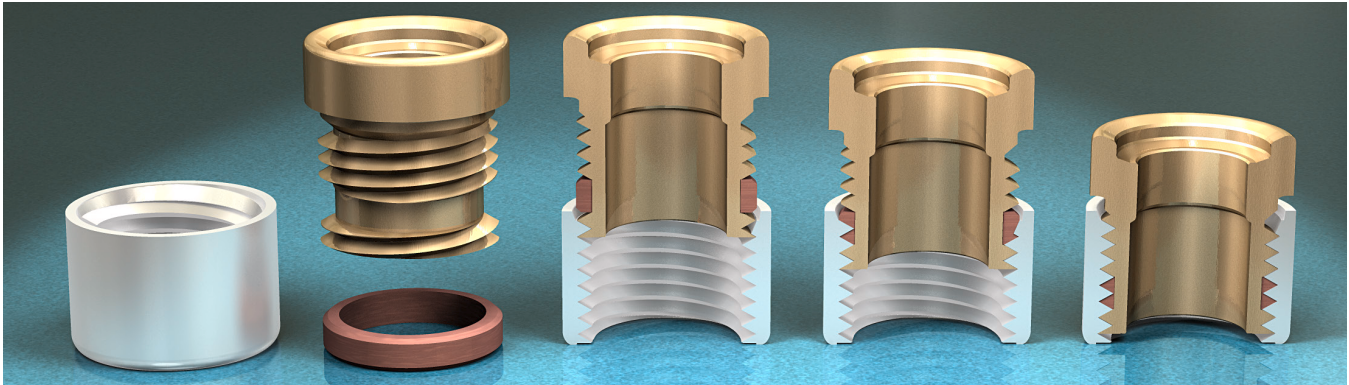

IPM-TEK's Ring Style THREAD SEALS were developed and tested extensively in the field. Our thread seals outperform traditional thread sealant tapes because of their robust design and method of application. Utilizing G439, a proprietary PTFE blend, specifically developed for this application, coupled with a machined groove, provides a method that ensures the thread channel is sealed completely. Thread sealant tapes can tear and stretch, leaving voids where leaks can occur. Contact IPM-TEK today to order the best thread seal we've ever made.

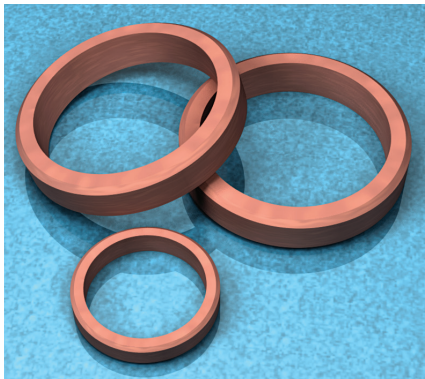

IPM-TEK's THREAD SEALS provide:

- Maximum sealing of the thread channel
- Specialized PTFE material easily expands for positioning over threads and into seal groove, then shrinks back to original size and is ready for assembly
- Tested and proven thread sealing for hydraulic applications.

A wide selection of standard sizes are available in stock:

1/4" : 12.2 x 9.4 x 3.6 mm	3/4" : 24.3 x 21 x 3.6 mm
3/8" : 15.3 x 12 x 3.6 mm	1" : 30.7 x 26.5 x 4.3 mm
1/2" : 19.3 x 16 x 3.6 mm	

Customized sizes available upon request.

Dimension of the groove:

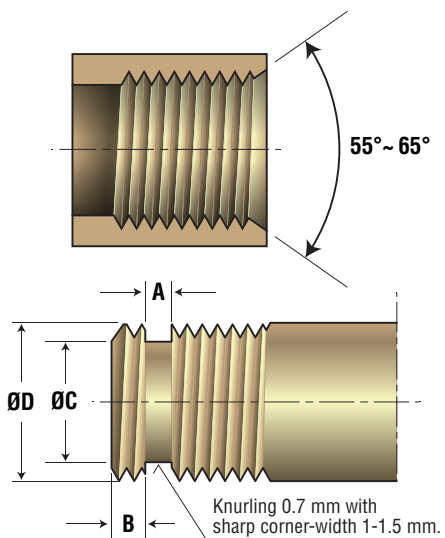

Thread	ØD Before Knurling (mm)	ØC	B Minimum (mm)	A (mm)
R 1-1/2"	43.6 ^{+0.2}		4.5	4.6 ^{+0.1}
R 1-1/4"	37.6 ^{+0.2}		4.5	4.6 ^{+0.1}
R 1"	29.1 ^{+0.1}		4.5	4.6 ^{+0.1}
R 3/4"	23.1 ^{+0.1}		3.5	3.7 ^{+0.1}
R 1/2"	17.6 ^{+0.1}		3.5	3.7 ^{+0.1}
R 3/8"	13.9 ^{+0.1}		3.5	3.7 ^{+0.1}
R 1/4"	10.4 ^{+0.1}		3.5	3.7 ^{+0.1}